

# 2, 3, & 4-Horse SLANT LOAD

GH Model Gooseneck



GH model Horse trailers have a fixed width of 6'-7" and include 3 standard floorplans for 2, 3, or 4 horses. The fixed width allows us to eliminate inner fenders and the associated labor and materials. A major benefit, aside from the dollar savings compared with our deluxe model Slant Load trailers, is the ability to extend the bottom rail and slats from front to rear without the customary gaps around the wheel wells; Contributing to an exceptionally strong side wall and floor. The bulkhead wall and dividers have a 54" offset. The combination of this offset and the 42" divider spacing provides a stall that is slightly larger than those found standard on our Deluxe Model Slant Load horse trailers. The floorplans and list of standard equipment shown here have evolved by listening to and incorporating the ideas of our customers. We believe they include the most popular features required by the average customer. We know that not everyone is average. That's why, with the exception of the width, nearly every other aspect of the trailer may be modified to suit your individual requirements.



## STANDARD FEATURES

- 16'-0" L x 7'-0" H x 6'-7" W
- 18'-0" L x 7'-0" H x 6'-7" W
- 22'-0" L x 7'-0" H x 6'-7" W
- 2 - 7000# Torsion Axle w/ Electric Brakes
- 5 - Ten Ply Radial Trailer Tires
- 16" Steel Wheels
- 2 5/16" Adjustable Coupler
- Single Drop Leg
- Tapered Gooseneck
- Polished Cast Corner Caps
- Pre-Painted White Exterior on Smooth Aluminum - To Bulkhead Wall Curbside, Full Length Streetside
- Front Dressing Room
- Carpet on Gooseneck Floor, Drop, Dressing Room Floor, & Bulkhead Wall
- Dressing Room Door w/Window
- Drop Down Feed Doors w/ Windows & Drop Down Window Bars Each Stall
- Single Side Wall Construction w/ 2 Air Cracks With Plexi-Glas® in Horse Compartment, Curbside
- Full Width Rear Door w/ 2 Air Cracks w/Plexi-Glas® at Top w/ Padded Safety Chain
- 3" Rubber Dock Bumper
- Permanent Bulkhead Wall
- Smooth Ribbed Aluminum Floor
- Floor Mats Full Length Horse Compartment
- Rubber on Front Bulkhead Wall
- Removable Half Dividers w/ Pads & Holdback

- 2-Way Roof Vents - See Stall Layouts On Page 2 For Number And Location
- 2 Trailer Ties Per Horse - Inside & Outside
- 2 Dome Lights
- Permanent Covered Saddle Rack Per Horse
- 10 Bridle Hooks On Bulkhead Wall
- Brush Tray On Dressing Room Door
- Halogen Load Light Over Rear & Dressing Room Doors
- High Turn Signals
- L.E.D. Lighting
- D.O.T. Tape

## POPULAR OPTIONS

- 2-Speed Drop Leg
- Feed Bags
- Double Anti-Rack Lock Rods On Rear Door
- W.E.R.M. Floor
- Boot Box
- Dome Vent In Dressing Room
- Polished Top Rail And Or Slats
- 8' Hay Rack
- Blanket Bar
- Stock Gate In Lieu Of Divider

All 4-Star Trailers Come With Our

**8 YEAR WARRANTY**

4-Star Trailers, Inc.  
10,000 N.W. 10<sup>th</sup> St. Oklahoma City, Ok 73127  
800-848-3095 • www.4startrailers.com  
All dimensions are approximate. Photos may show options.



# 2, 3, & 4-Horse SLANT LOAD

GH Model Gooseneck

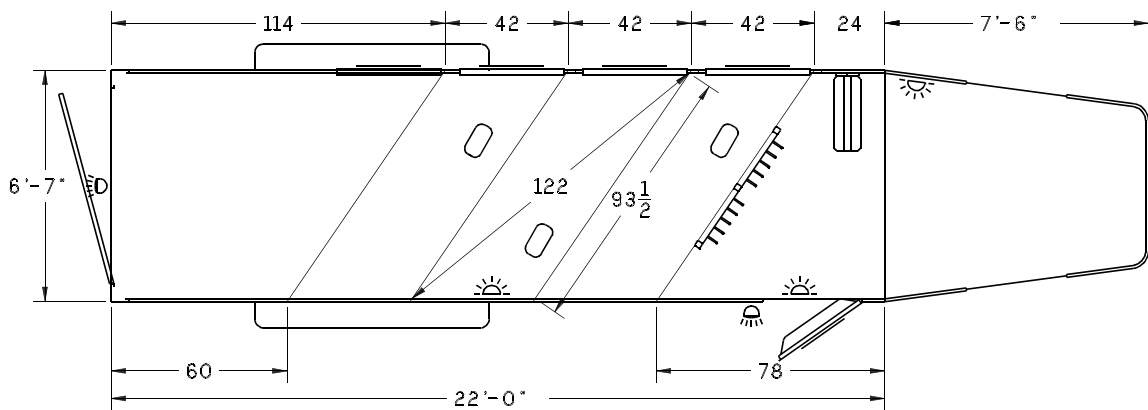
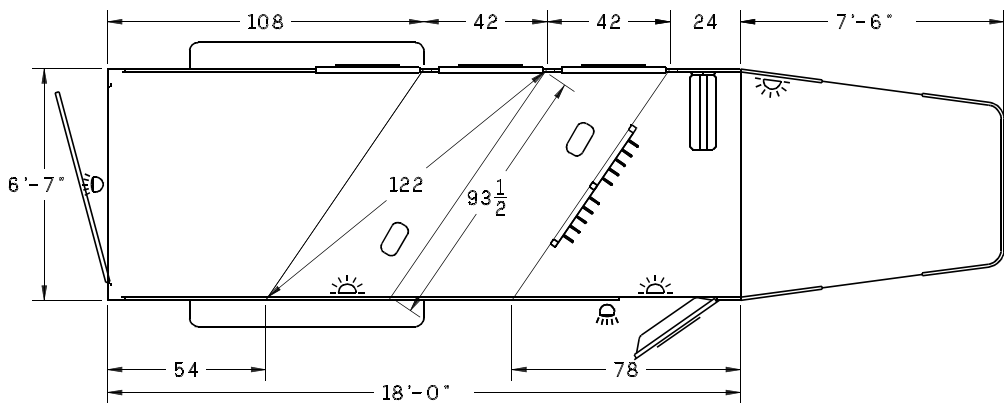
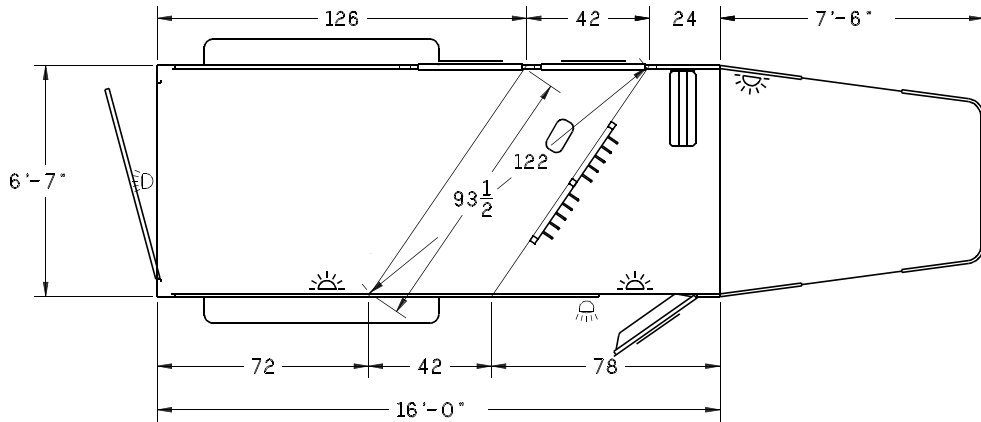

4-Star Trailers, Inc.  
 10,000 N.W. 10<sup>th</sup> St. Oklahoma City, Ok 73127  
 800-848-3095 • [www.4startrailers.com](http://www.4startrailers.com)  
 All dimensions are approximate. Photos may show options.