

# Stock-Combo

## Bumper Pull

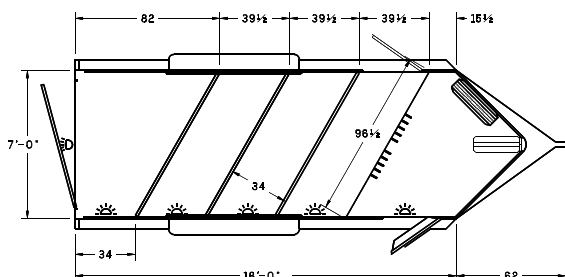

The versatility of these trailers make them some of our most popular models. These combination horse/stock trailers are as much at home on the cattle ranch as they are at the horse show. This informational brochure highlights the floor plans of the 3 most popular bumper pull models representing three decades of listening to our customer's desires and delivering trailers that fulfill them.

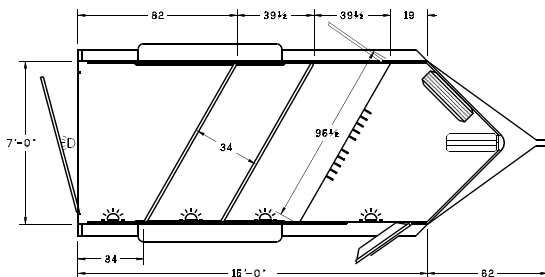
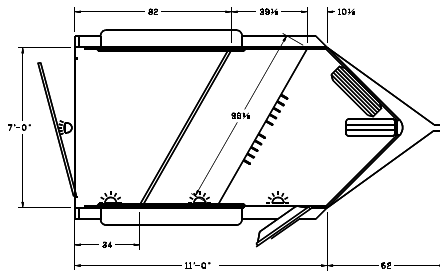

### STANDARD FEATURES

- 11'-0" L x 7'-0" W x 7'-0" Ht
- 2 - 3500# Torsion 102" Axles w/ Electric Brakes/5-Bolt Hub
- 5 Six Ply Radial Trailer Tires
- 15" Aluminum Wheels
- Dressing Room Approx 25 Sq. Ft.
- 1 Two-Way Roof Vents
- 3 Dome Lights

- 15'-0" L 7'-0" W x 7'-0" H
- 2 - 5200# Torsion 102" Axles w/ Electric Brakes/8-Bolt Hub
- 5 Ten Ply Radial Trailer Tires
- 16" Aluminum Wheels
- Dressing Room Approx 30 Sq. Ft.
- Standard Stock Door w/Breast Bar First Horse
- 2 Two-Way Roof Vents
- 4 Dome Lights
- D.O.T. Reflective Tape

- 18'-0" L 7'-0" W x 7'-0" H
- 2 - 7000# Torsion 102" Axles w/ Electric Brakes/8-Bolt Hub
- 5 Ten Ply Radial Trailer Tires
- 16" Aluminum Wheels
- Dressing Room Approx 28 Sq. Ft.
- Standard Stock Door w/Breast Bar First Horse
- 3 Two-Way Roof Vents
- 5 Dome Lights
- D.O.T. Reflective Tape

- 2 5/16" Adjustable Coupler
- Pad Type Jack
- Tongue Lenth 62"
- Wedge Nose
- Polished Cast Corner Cap
- Pre-Painted White Exterior on Smooth Aluminum
- Front Dressing Room"
- Carpet on DR Floor
- Dressing Room Door w/ Window

- Single Side Wall Construction w/ 2 Air Cracks in Horse Compartment
- Full Width Rear Door w/ 2 Air Cracks at Top w/Padded Safety Chain
- 3" Rubber Dock Bumper
- Permanent Bulkhead Wall
- Ribbed Tread Plate Aluminum Floor
- Floor Mats Full Length Horse Compartment
- Stall Mats Full Length Horse Compartment And Rear Door
- Rubber on Front Bulkhead Wall
- Rubber Wheel Wells Has Photo
- Removable Half Dividers w/ Pads & Holdback
- 2 Trailer Ties Per Horse - Inside & Outside
- Covered Saddle Rack Per Horse
- 5 Dome Lights
- 1 Brush Tray
- 10 Bridle Hooks
- High Turn Signals
- Halogen Load Light At Rear
- L.E.D. Lighting

### POPULAR OPTIONS

- Additional Height, Length, Width
- Removable Plexi-Glas® Air Crack Covers
- Gravel Guard
- 

All 4-Star Trailers Come With Our

8 YEAR WARRANTY

4-Star Trailers, Inc.

10,000 N.W. 10<sup>th</sup> St. Oklahoma City, Ok 73127

800-848-3095 • www.4startrailers.com

All dimensions are approximate. Photos may show options.

